

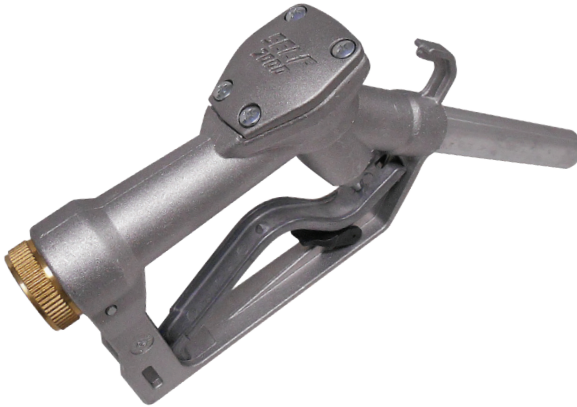

DIESEL

**CARATTERISTICHE - FEATURES**

Portata max - Flowrate max [l/min - GMP]	150 - 32
Entrata - Inlet	1" F
Pressione max - Pression max [bar]	3,5
Spout [Ø]	25
Girevole - Swivel	sì - yes
Fermo leva - Stop Lever	sì - yes
Fluidi consentiti - Allowed fluids	diesel
Materiale corpo - Body material	alluminio - aluminium
Materiale guarnizioni - Gaskets materials	NBR (Viton su richiesta - Viton on request)
Materiale raccordo - Fitting material	ottone - brass





Plastic manual nozzle



DIESEL



FOOD



DIESEL

FEATURES	DIESEL	FOOD
Max Flow Rate [l/min / GPM]	80 / 21,13	80 / 21,13
Inlet [BSP/G]	3/4" M	3/4" M
Max pressure [bar / psi]	3.5 / 51	3.5 / 51
Hose stem [Ø]	20/25	20/25
Swivel	yes	yes
Stop lever	optional*	optional*



(*) Available only on request

Stop lever locks the nozzle in refuelling position, the unlocking is completely manual.

Adam pumps is not responsible for any damage to things or persons made using stop lever.